

EVERLITE

DANPALON®

■ FACADE ■ ROOFING ■ CANOPY ■ INTERIOR



THE LIGHT ENVELOPE

OUR SOLUTIONS AT THE SERVICE OF AUDACIOUS AND BRIGHT ARCHITECTURE

Danpalon® offers innovative and flexible solutions for the building envelope, which ensure the comfort of natural light and high-quality thermal performance.



Danpalon®, the first connectable polycarbonate system, has taken the architectural world by storm due to its outstanding technical and aesthetic features.

The translucent system, which has constantly evolved since its inception in 1980, is developed based on a high-quality synthetic material, the Makrolon® polycarbonate, and is reputed for its exceptional mechanical features.

Its performances are confirmed by the most prominent certification bodies. The large variety of aspects, colours, finishes and specific effects provide a formidable range of innovative, creative options.

BENEFITS OF DANPALON®

- UNIQUE MICROCELLS
- UNPARALLELED DESIGN
- SURPRISINGLY LIGHTWEIGHT
- EXCELLENT LIGHT TRANSMISSION
- EXCELLENT THERMAL PERFORMANCE
- SUPERIOR AIR AND WATER TIGHTNESS
- HIGH IMPACT RESISTANCE
- QUICK, EASY AND COST EFFECTIVE INSTALLATION
- RECYCLABLE MATERIALS
- SYSTEM CERTIFIED TO EN STANDARDS BY CSTB AND SOCOTEC

■ Cover: House of architecture, Vigo (Spain), Danpalon® clear, Architects: Irasarry y Pineru
© Photo: Manuel Vicente



DANPALON® THE CONSTRUCTIVE SYSTEM

UNIQUE MICROCELL STRUCTURE

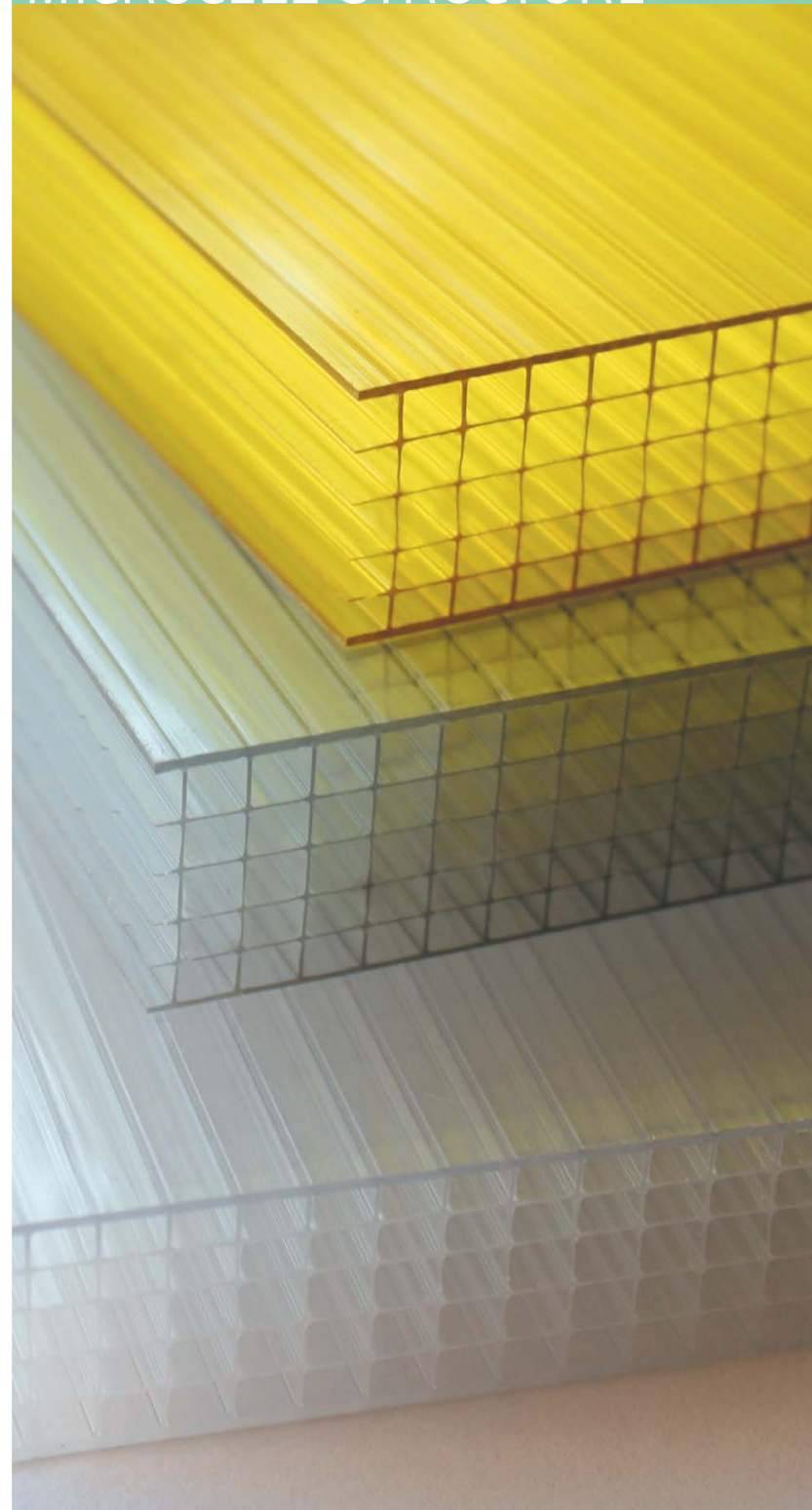

- State of the art extrusion technology.
- Highest structural mechanical performance on the market.
- Unparalleled impact resistance (hard and soft materials).

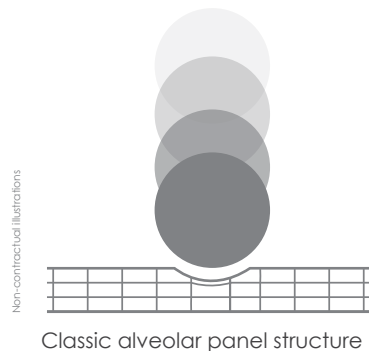
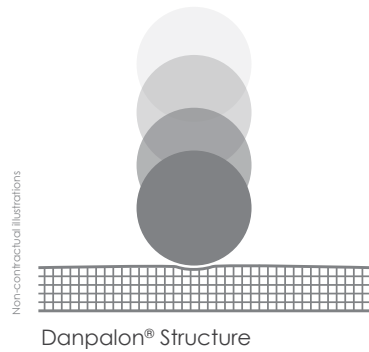

- Exceptional light diffraction and diffusion capacities.
- Dense structure, suitable for cold curving, or thermoforming.
- Unequalled aesthetic design.

HIGH-SECURITY DOUBLE NOTCHING

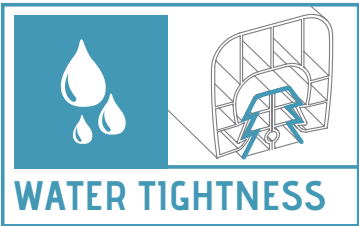

- Reinforced safety gauge.
- Improved inertia for improved lightness.
- The very best air and water tightness available.

DURABILITY GUARANTEE

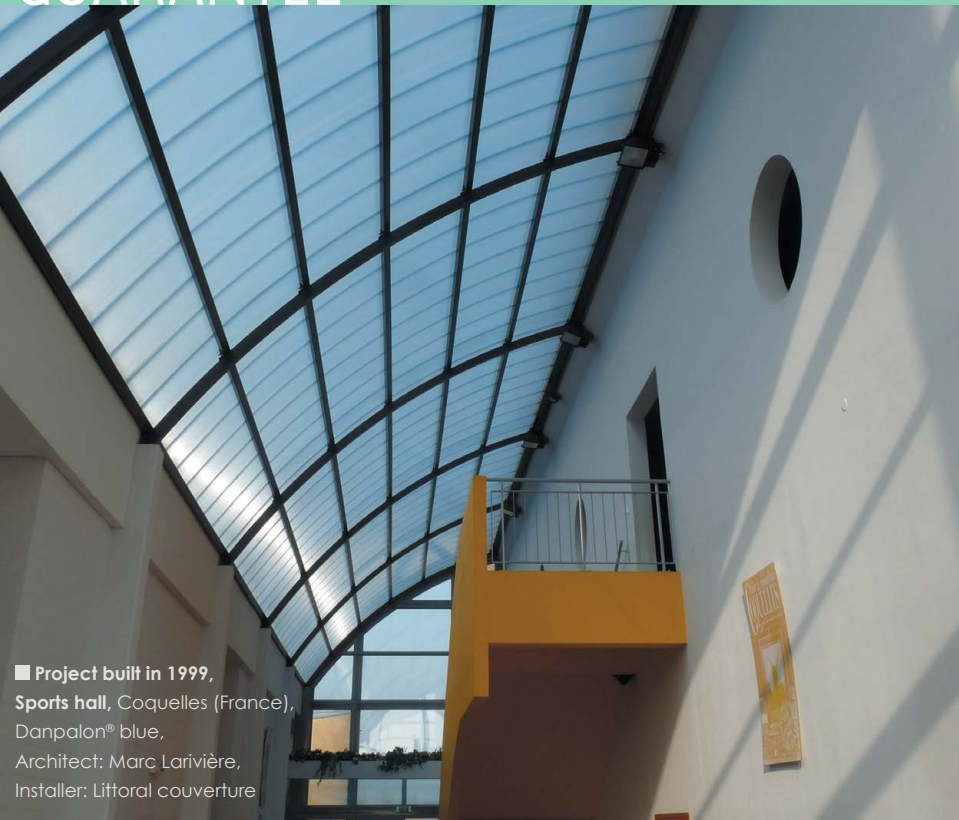

- Equipped with excellent U.V. protection capabilities, Danpalon® is highly resistant to weathering and our projects from around the world of 25 years and more stand testament to this quality.

DANPALON® FACADE

Thanks to its unsurpassed light control and transmission capabilities, Danpalon® magnifies your facades for enhanced aesthetics and comfort. By day, enjoy a pleasant natural light. By night, unveil a building full of character.



■ Totexth Fire Fit Hub, Liverpool (United-Kingdom),
Danpalon® blue, green, ice, Architects: Cass Associates,
Installer: K2 Aluminium Systems Ltd

Photo: David Millington

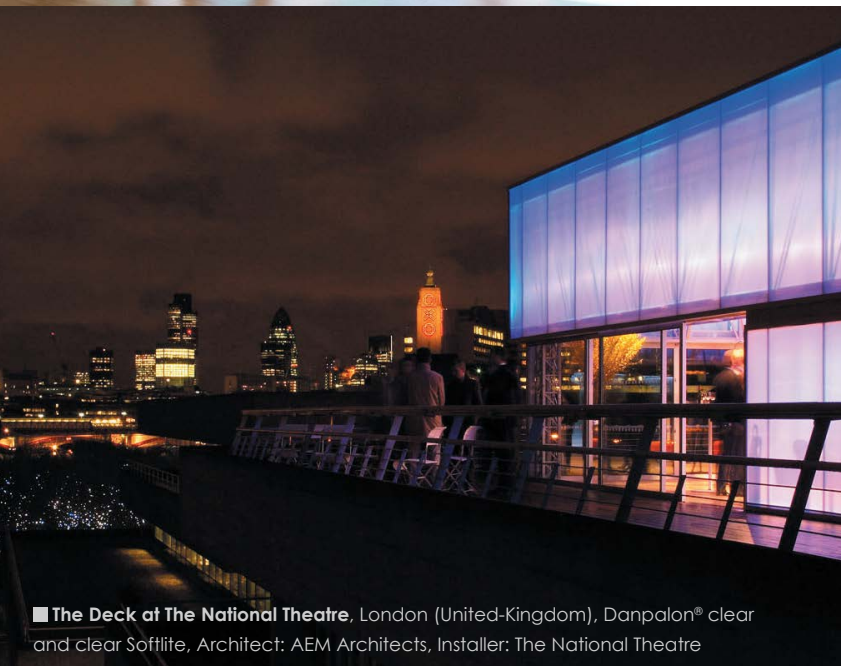

■ The Deck at The National Theatre, London (United-Kingdom), Danpalon® clear
and clear Sofflite, Architect: AEM Architects, Installer: The National Theatre

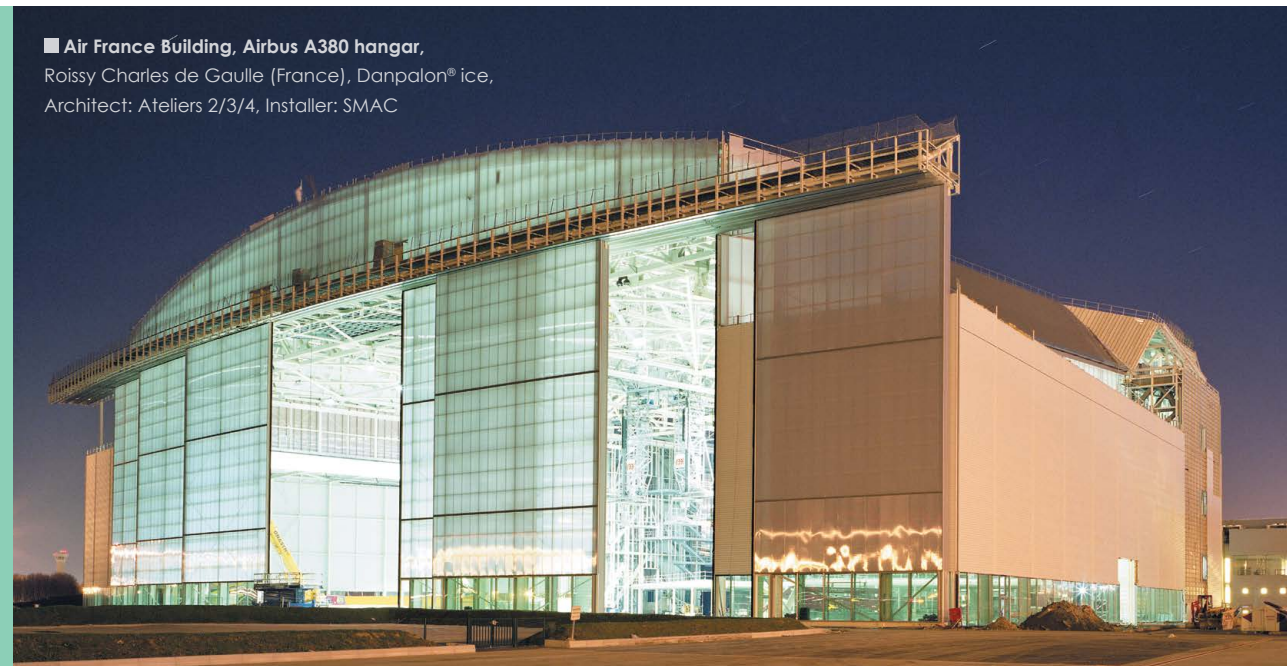

■ Air France Building, Airbus A380 hangar,
Roissy Charles de Gaulle (France), Danpalon® ice,
Architect: Ateliers 2/3/4, Installer: SMAC

Photo: Yves Wechard



■ Maison de l'avocat, Nantes (France), Danpalon® clear,
Architect: FORMA 6, Installer: Girard Hervouët



■ Blackburn Youth Zone, Blackburn (United-Kingdom),
Danpalon® orange, Architect: Eric Wright Group

Photo: David Millington



■ Fire station, Lancy (Switzerland),
Danpalon® red,
Architect: DMA,
Installer: Brandt

Photo: Pascal Pasquier



■ Vue Cinema, Trinity Square,
Gateshead (United-Kingdom), Danpalon® ice
Architect: 3D REID, Installer: KeyClad Limited

Photo: Steve Meyer Photography

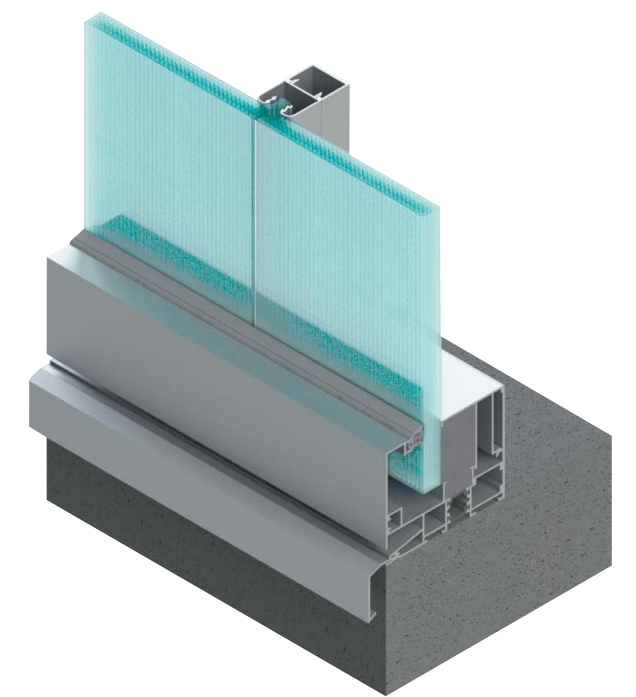

DANPALON® ROOFING

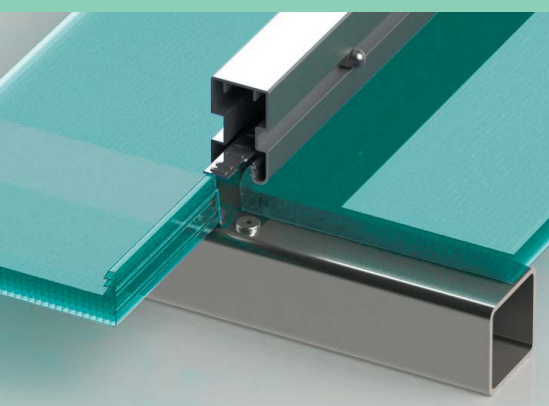

■ Lightweight, flexible, extremely resistant (hail) and available in large sizes, Danpalon® roofing systems adapt to all your needs to create protective and bright spaces.



■ **Metz Maintenance centre**, Metz (France), Danpalon® green, Architects: Denu et Parodon, Installers: Coovrest, Cibetanche Descartes

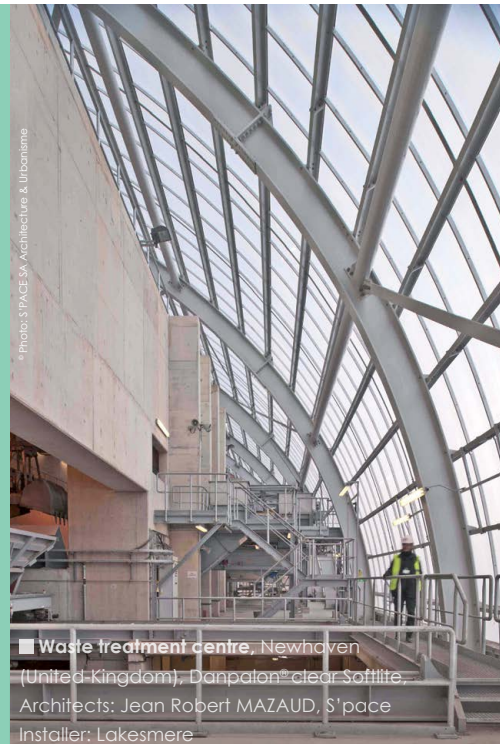

■ **Waste treatment centre**, Newhaven (United Kingdom), Danpalon® clear Softlite, Architects: Jean Robert MAZAUD, S'pace, Installer: Lakesmere

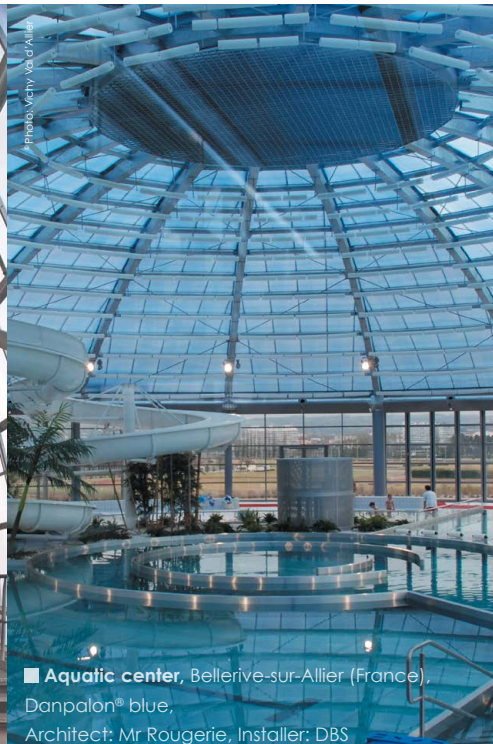

■ **Aquatic center**, Bellerive-sur-Allier (France), Danpalon® blue, Architect: Mr Rougerie, Installer: DBS

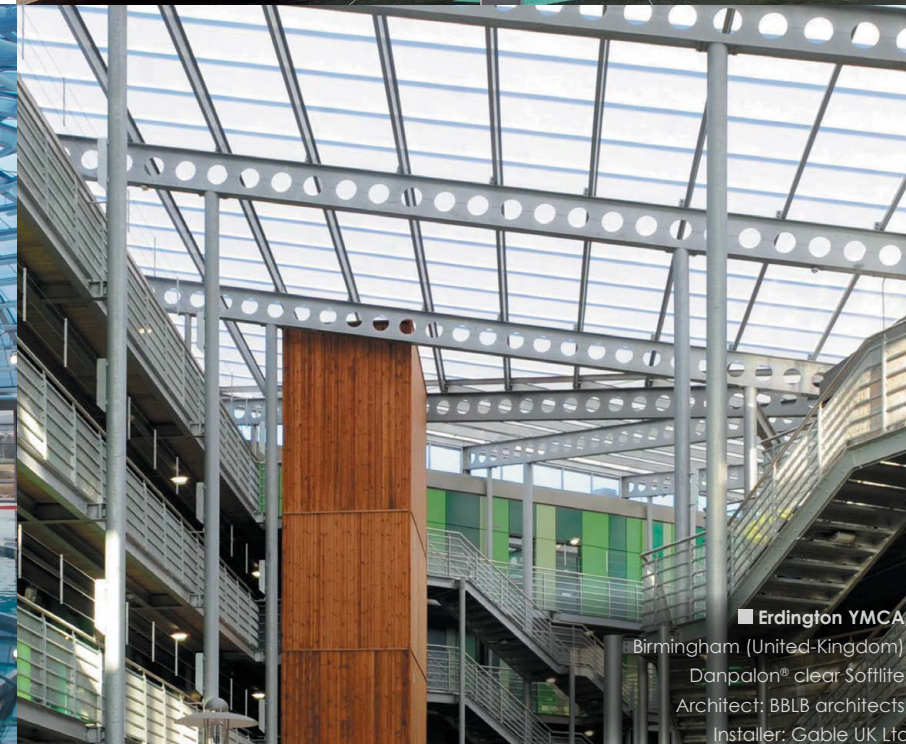

■ **Erdington YMCA**, Birmingham (United Kingdom), Danpalon® clear Softlite, Architect: BBLB architects, Installer: Gable UK Ltd



■ **Horse-riding Arena**, Feyzin (France), Danpalon® lime and clear, Architect: Jean-Pierre Givord, Installer: Rhône Alpes Acier

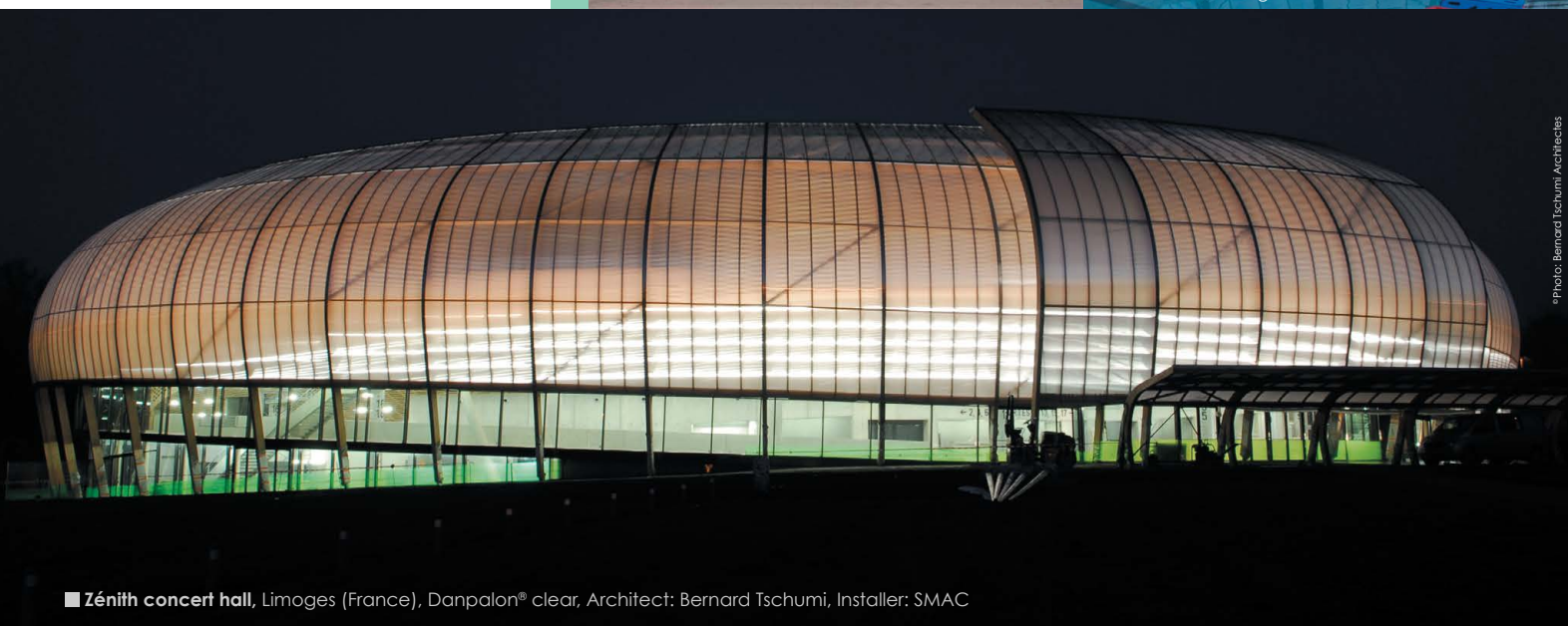

■ **Zénith concert hall**, Limoges (France), Danpalon® clear, Architect: Bernard Tschumi, Installer: SMAC



■ **The Jean Alric Stadium terraces**, Aurillac (France), Danpalon® red Softlite, ice Softlite, Architects: A+ Architecture, Installer: Atelier de Chaudronnerie du Cantal

DANPALON® DOUBLE



■ Danpalon® Double is constructed from two panels that create an insulating air space. Historically, it is the first completely translucent heat insulation system.

■ This flexible system is suitable for all roofing and facade bold design ideas (curved or straight). Surprise yourselves by playing with the large variety of colours and finishes.



■ **ESLA (Entreprise South Liverpool Academy)**, Liverpool (United-Kingdom), Danpalon® double ice - Architects: BDP
Installer: Weatherwise (Special Projects) Ltd

Photo: David Millington



■ **Ciné 32**, Auch (France), Danpalon® double clear and clear Softlite
Architect: Encore Heureux, Installer: SNA Sud-Ouest

Photo: Sébastien Normand



■ **Saint Thomas' Church**, Vaulx-en-Velin (France), Danpalon® double clear and ice Softlite
Architects: [Siz-ix] Architectes, Installer: Franck Saine

Photo: Franck Saine



■ **Camille Fournet factory**, Tergnier (France), Danpalon® opal, ice, clear Softlite, Danpalon® double ice, clear Softlite with leds
Architect: Atelier Boris Cindric, Installer: Rossi

Photo: Eric Mathin

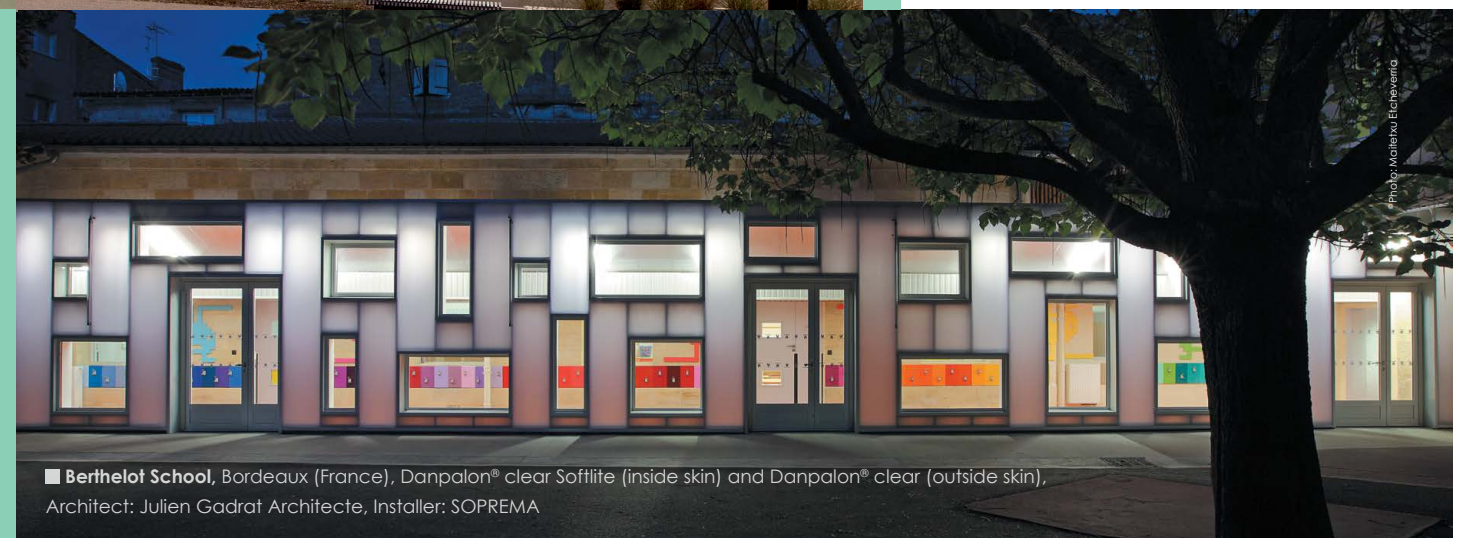

■ **Berthelot School**, Bordeaux (France), Danpalon® clear Softlite (inside skin) and Danpalon® clear (outside skin),
Architect: Julien Gadrat Architecte, Installer: SOPREMA

Photo: Mathieu Echeverria



■ **Velodrome, Roubaix** (France), Danpalon® Double clear Softlite, Architects: ANAA Architectes, Installer: Carlier Lescut, Demathieu et Bard, Engineers: PROJEX

Photo: David Coppieters

DANPALON® INTERIOR



■ **Sunset Coast CLC**, Joondalup (Australia),
Danpalon® opal



■ **Dauphine university canteen**, Paris (France),
Danpalon® clear,
Architects: SCP Beguin & Macchini,
D.E.N.S.A.I.S Architects,
Installer: A.M.T



■ **The Alliance Française in Bangkok** (Thailand),
Danpalon® orange and silver,
Architect: ADPI,
Installer: TT Construction Co Ltd



■ **Nursery Eiders**, Paris (France), Danpalon® orange,
Architect: Pablo Katz Architecture, Installer: BMG



■ **Techno cafe university**,
Durham (United-Kingdom), Danpalon® opal,
Architect: PH Partnerships,
Installer: T Mannets

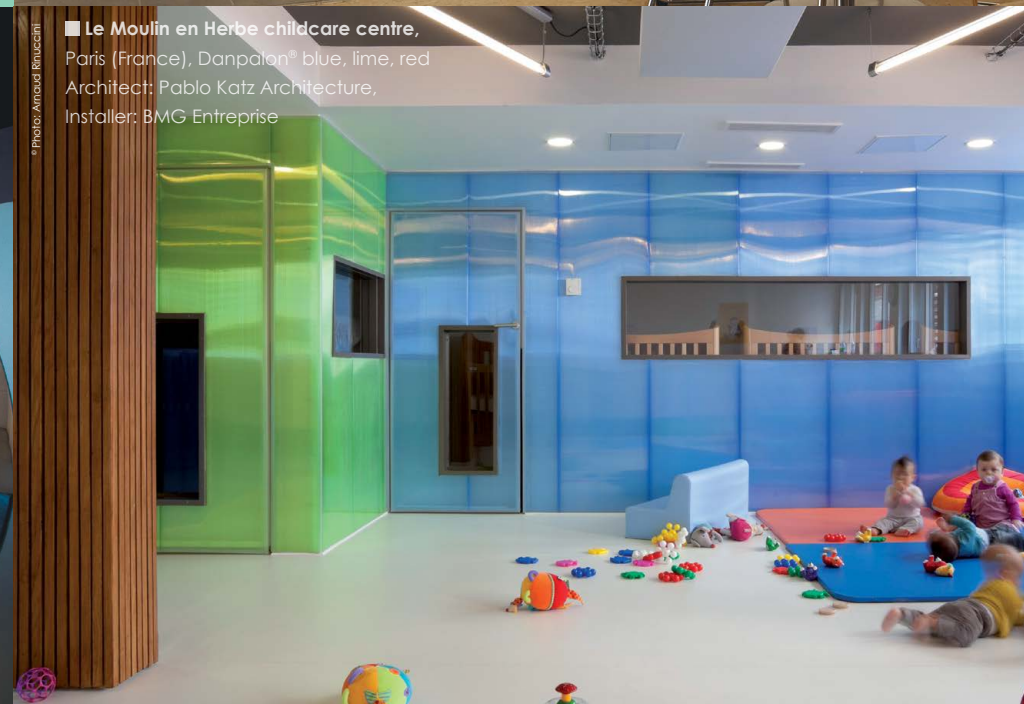

■ **Le Moulin en Herbe childcare centre**,
Paris (France), Danpalon® blue, lime, red
Architect: Pablo Katz Architecture,
Installer: BMG Entreprise



■ **Grand Palais**, Lille (France), Danpalon® opal
Architects: Zero 3.2 Architect, Installer: Module

■ Walls, partitions and false ceilings open up under the effect of the light setting. Danpalon® brightens your interior spaces to create a subdued ambient and an exciting atmosphere.

DANPALON® DECORATION



■ A touch of creativity, Danpalon® invites you to explore new aesthetic dimensions. Digital printing, adhesive film, screen printing... By associating image and light, Danpalon® helps create "evolving" spaces where decoration is transformed by light.

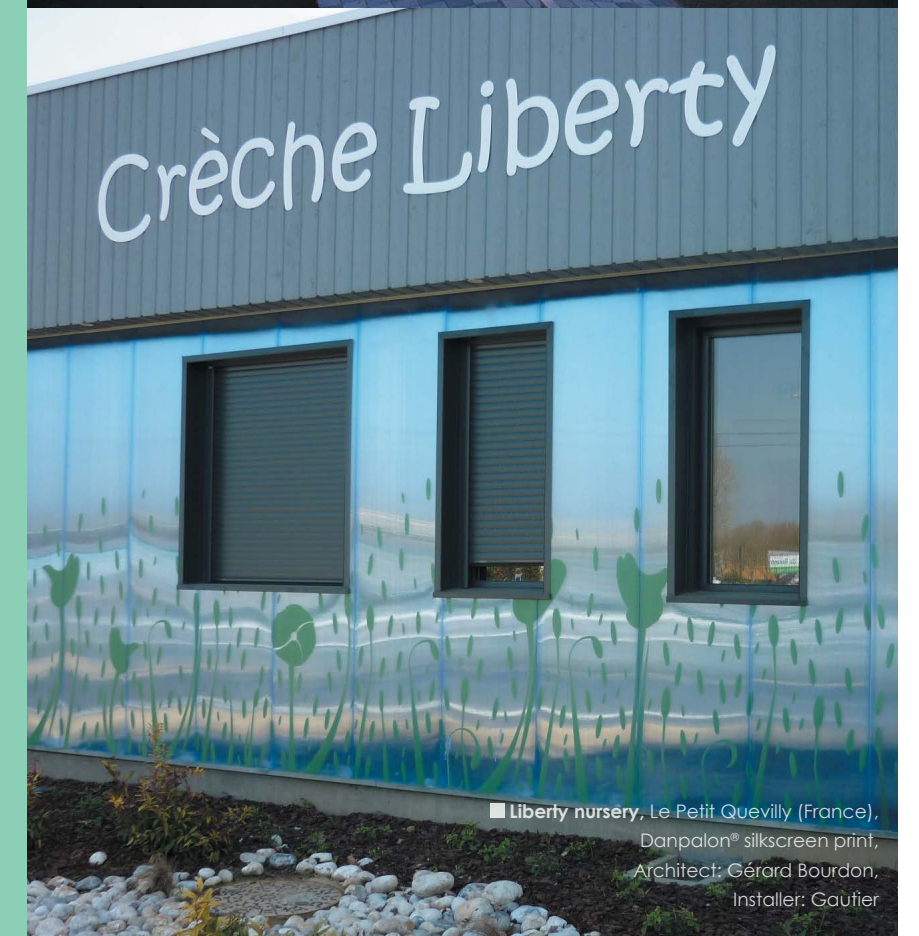
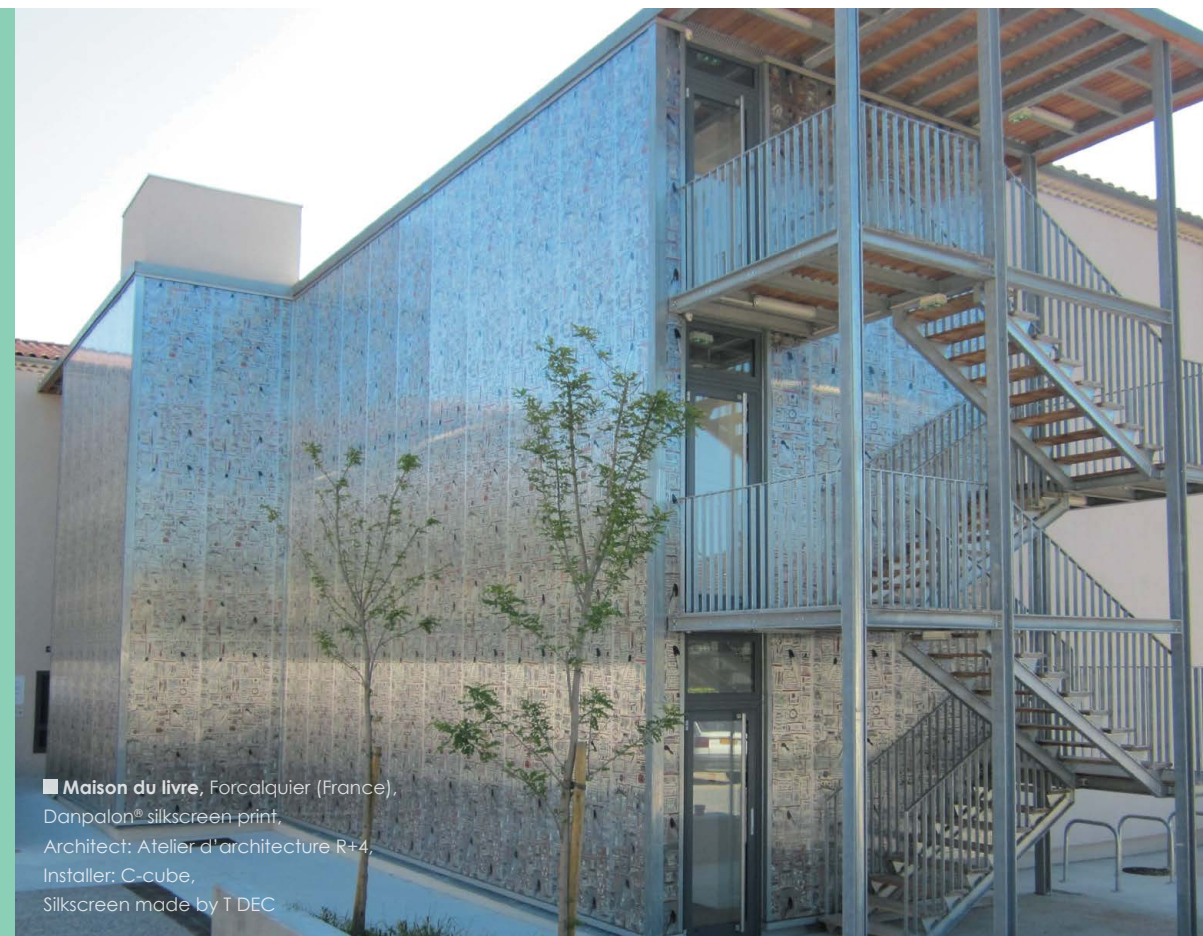

DANPALON® FINISHING



SOFTLITE FOR UNPARALLELED VISUAL COMFORT

■ Softlite finishing greatly diminishes glare effects.

Characterised by a matt aspect, Softlite is applied by co-extrusion on Danpalon® panels of any thickness and colour and is 100% permanent. The Softlite finishing is independently validated. It eliminates the glare effect and ensures maximum visual comfort regardless of the exposure and type of building.

HIGH PROTECTION TREATMENT

■ This finish is particularly adapted to facades and low level partitions, as it reduces the risk of potential damage from increased public presence, repeated friction or voluntary deterioration.

The high protection finish helps to slightly increase the resistance of the treated side to abrasion, scratching, scraping... It also improves and facilitates the cleaning of graffiti* by means of specifically adapted cleaning products.

*We recommend testing the surface first, as certain markers or paints may be indelible.



■ **Medical center**, Joeuf (France), Danpalon® clear, HP finish,
Architect: Mr Vincent, Installer: SOPREMA

INFRARED TREATMENT

■ This specific treatment applied to the Danpalon® panels significantly limits solar heat without affecting light transmission, thus directly contributing to the summer comfort and the bioclimatic efficiency*.

*Taking into account the infrared wavelengths, green, blue and purple panels provide the best performance.

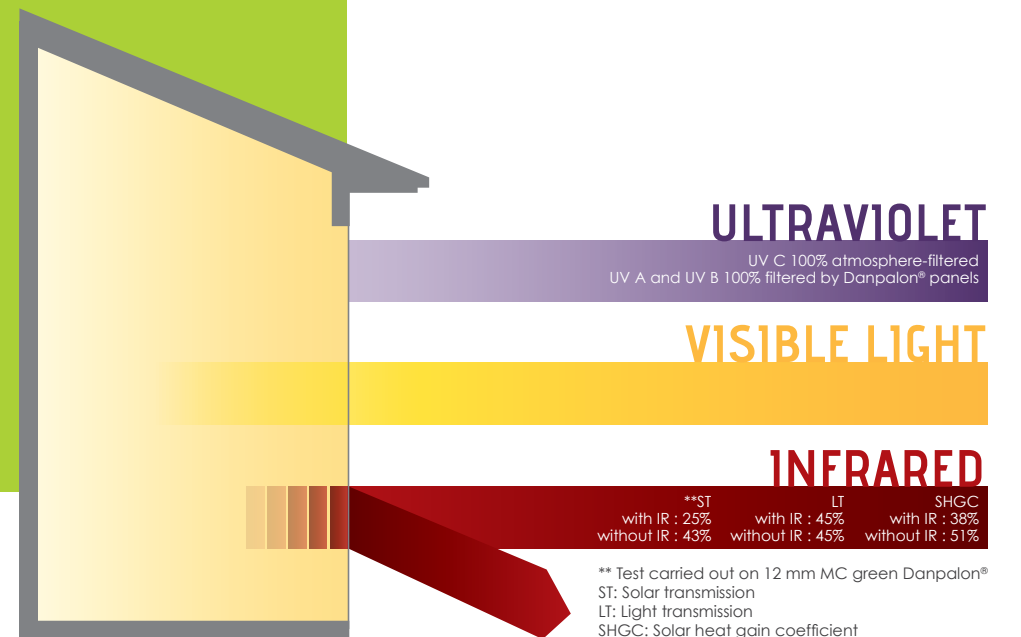

IRIDESCENT ASPECT FOR CONTROLLED RADIATION

■ The treatment applied on the Danpalon® panels greatly improves heat performance due to their capacity to reflect infrared rays. Its pearlescent aspect that changes according to the angle of view and is surprising and attractive.



HEAT WELDED EDGES FOR PERFECT FINISHING

■ The welded edges provide a clean and effective solution that prevents water, dirt or insects from getting inside the microcells. The assembly of the Danpalon® panels is also facilitated, as no panel end caps or tape are needed.

WIDE COLOUR RANGE FOR A CUSTOMIZED PROJECT

■ A wide range of standard colours is available to match your requirements in terms of creativity and imagination.

■ Sofllite option

To limit the glare effect and to obtain a matt finish, the Sofllite treatment (anti-glare) that complies with CSTB report no. EN-ECL 05.10.C is available on request.



Please refer to our technical manual to see the transmission, reflection and solar factor values according to colour and thickness. For specific colours and treatments, please contact us. The standard colour combinations that are not subject to production costs are available on request.

BICOLOUR FOR DOUBLE EFFECT

■ Our bicolour option gives you the possibility to perfectly adapt your facades to the effect you desire both inside and outside. It is available in the colours of your choice on all our Danpalon® systems (under specific sales conditions).

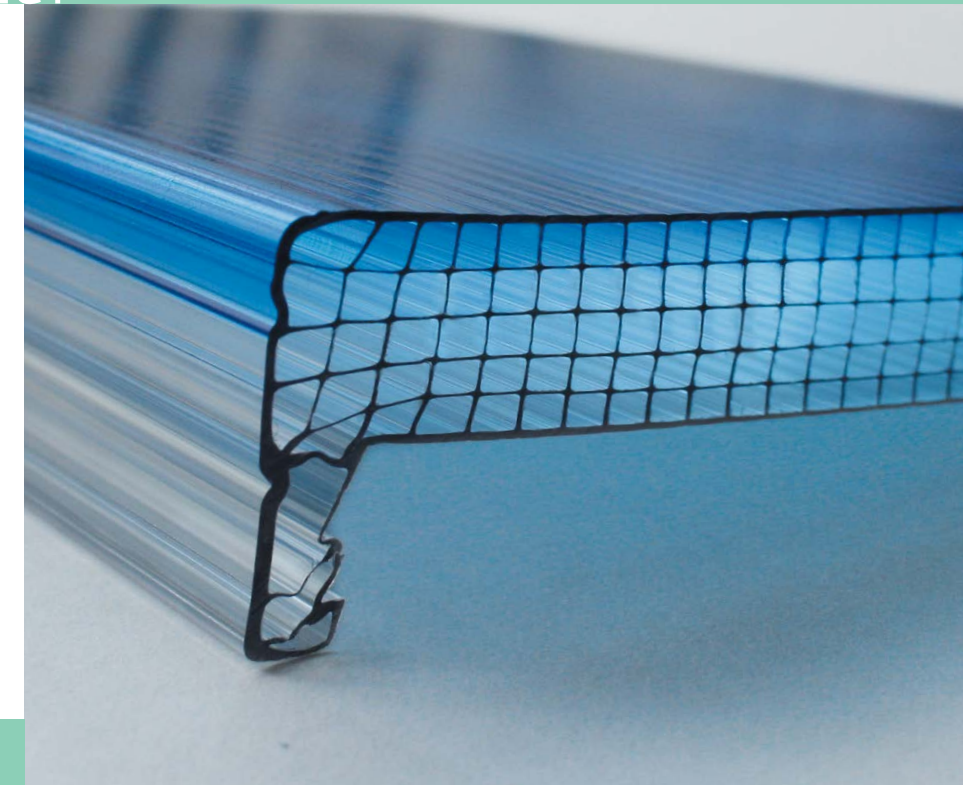

ONE COLOUR ONE SIGNATURE



■ Create a unique colour signature for your project.

Imagine, create and we will produce the colour of your choice. Please contact us to find out about our terms and delivery times.

MAINTENANCE

Danpalon® requires environmentally friendly maintenance. The low surface tension of Danpalon® systems allows the panels to be effectively cleaned simply by using water and soft soap. Never use abrasive cleaning products.

TECHNICAL FEATURES

		DANPALON® FACADE AND ROOFING				
		DANPALON® 8 mm	DANPALON® 10 mm	DANPALON® 12 mm	DANPALON® 16 mm	DANPALON® 22 mm
Structure		Multicell (MC)				
Number of walls		4	4	4	6	6
Thickness (mm)		8	10	12	16	22
Width (mm)		600	600	600 - 900	600 - 900 - 1040	600 - 900
Length		Standard up to 12 m ⁽¹⁾				
Weight of the panel (kg/m²)		1,8	2,4	2,6	3,3	3,7
Fire resistance ⁽²⁾		B-s2,d0				
Ug (W/m².K) (according to Th-U rules)		3	2,6	2,4	1,9	1,5
Spanning (maximum) (m) ⁽³⁾ (value for 600 mm width)	Polycarbonate connector	1	1,2	1,2	1,6	1,6
	Aluminium connector	2,5	2,5	2,5	2,5	2,8
	High span aluminium connector for facade	On request				3,2
	Freespan aluminium profil for roofing	4	4	-	5	-
Minimum roof slope (connector installed to the external)		5° (or 9%) ⁽⁴⁾				
Minimum radius for cold bending (m)		1,6	2	2,5	3	3,5
Soft and hard body impact		D1-10J; M50-300J; M50-400J				
Non-fragility		Roofing: 1200J - Class B / Facade: 600J				
Stability in seismic zone		All area all buildings				
ISO Certifications		Manufacturer certified ISO 9001 & ISO 14001				
Warranty		10 years manufacturer warranty (panels)				

(1) Longer upon request

(2) Euroclass following SBI (Single Burning Item) tests protocol established according to EN 13501-1

(3) Permissible loads corresponding to high pressure/low pressure under normal wind according to regulation NV65 modified.
For more information, please see the load tables in the technical documents at www.everliteconcept.com

(4) Individual assessment for lower slope

CE marking in accordance with EN 16153

NB : All information is provided for information purposes only and are subject to changes in time

DIMENSIONS AND STRUCTURES

Danpalon® panels are designed with multiple dimensions and cell structures according to thickness to offer solutions that match your requirements.

Danpalon® 8 Multicell

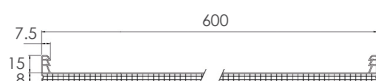

Danpalon® 10 Multicell

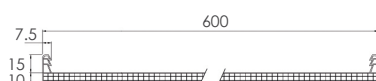

Danpalon® 12 Multicell

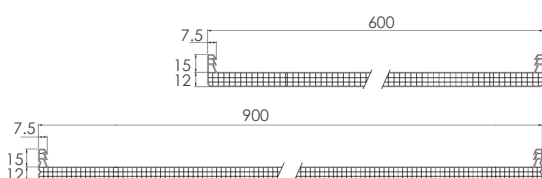

Danpalon® 16 Multicell

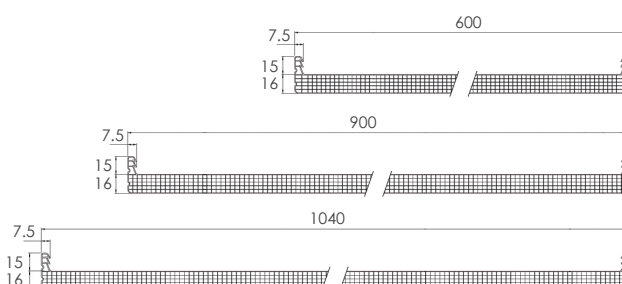

Danpalon® 22 Multicell

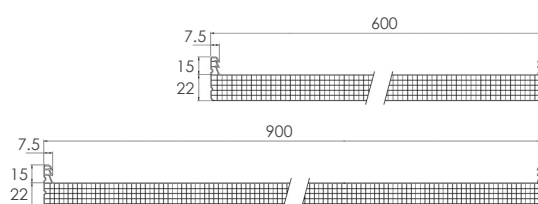

EVERLITE

View all of our systems at WWW.EVERLITECONCEPT.COM

EVERLITE CONCEPT S.A.S, 2-6, rue Condorcet, 91353 Grigny Cedex,
France - T: +33 (0)1 69 02 85 85, everlite.concept@everlite.fr